

Linha: Sala

Mod.: Home Suspense

Cód.: 1.624

 Canal do Montador
 Acesso e Participel

 ESQUEMA DE MONTAGEM
 ASSEMBLY INSTRUCTIONS
 ESQUEMA DE MONTAJE

Obs: Usar caixa de embalagem para fôrmar o chão na hora da montagem.
 Note: Use the packing box to cover the floor at the time of assembly.
 Nota: Utilice la caja de embalaje para cubrir el suelo en el momento del montaje.

 COLIBRI - IND. COM. DE MÓVEIS LTDA.
 Rua Rouxinol, 5530 - Fone/Fax: (43) 3275 - 8600
 Pq. Industrial XI - CEP 86.706-410 - Araçatunga - PR
 E-mail: sac@colibrinoveis.com.br
 Site: www.colibrinoveis.com.br

Cód.	Referência	Natura R / OH/W	Cor	Peças	Qt.	Medidas	M. p.	Piece	Pieza
01	1624A0.001		690	Prateleira	1	1780x160x25	MDP Shelf		Estante
02	1624A0.002		700	Tampo	1	1780x320x25	MDP Cover		Cubierta
03	1624A0.003		700	Prateleira menor	1	698x278x15	MDP Smaller shelf		Estante pequeno
04	1624A0.004		700	Base	1	1780x300x15	MDP Base		Base
05	1624A0.005		700	Painel superior	1	1800x540x15	MDP Top panel		Panel mayor
06	1624A0.006		700	Painel central	1	1800x540x15	MDP Central panel		Panel central
07	1624A0.007		700	Painel inferior	1	1800x540x15	MDP Lower panel		Panel por debajo
08	1624A0.008		690	Vista	3	955x70x15	MDP View		Vista
09	1624A0.009		690	Porta esquerda	1	545x243x15	MDP Left door		Puerta izquierda
10	1624A0.010		690	Porta direita	1	545x243x15	MDP Right door		Puerta derecha
11	1624A0.011		690	Lateral esquerda	1	300x240x15	MDP Left side		Lateral izquierda
12	1624A0.012		690	Divisão esquerda	1	300x240x15	MDP Left division		División izquierda
13	1624A0.013		690	Divisão direita	1	300x240x15	MDP Right division		División derecha
14	1624A0.014		690	Lateral direita	1	300x240x15	MDP Right side		Lateral derecha
15	1624A0.015		700	Travessa lateral maior	2	1130x70x15	MDP Largest side crossbar		Travesaño lateral mayor
16	1624A0.016		700	Travessa lateral menor	2	490x70x15	MDP Minor side guard		Travesaño lateral menor
17	1624A0.017		99	Travessa	4	1100x80x15	MDP Travessa		Travesaño
18	1624A0.018		99	Travessa central	1	400x70x15	MDP Central beam		Travesaño central

Para pedidos de Assistência Técnica, agrupar a Referência da Peça com o nº da Cor. Ex: 1624A0.001.690 (Prateleira na cor Off White)

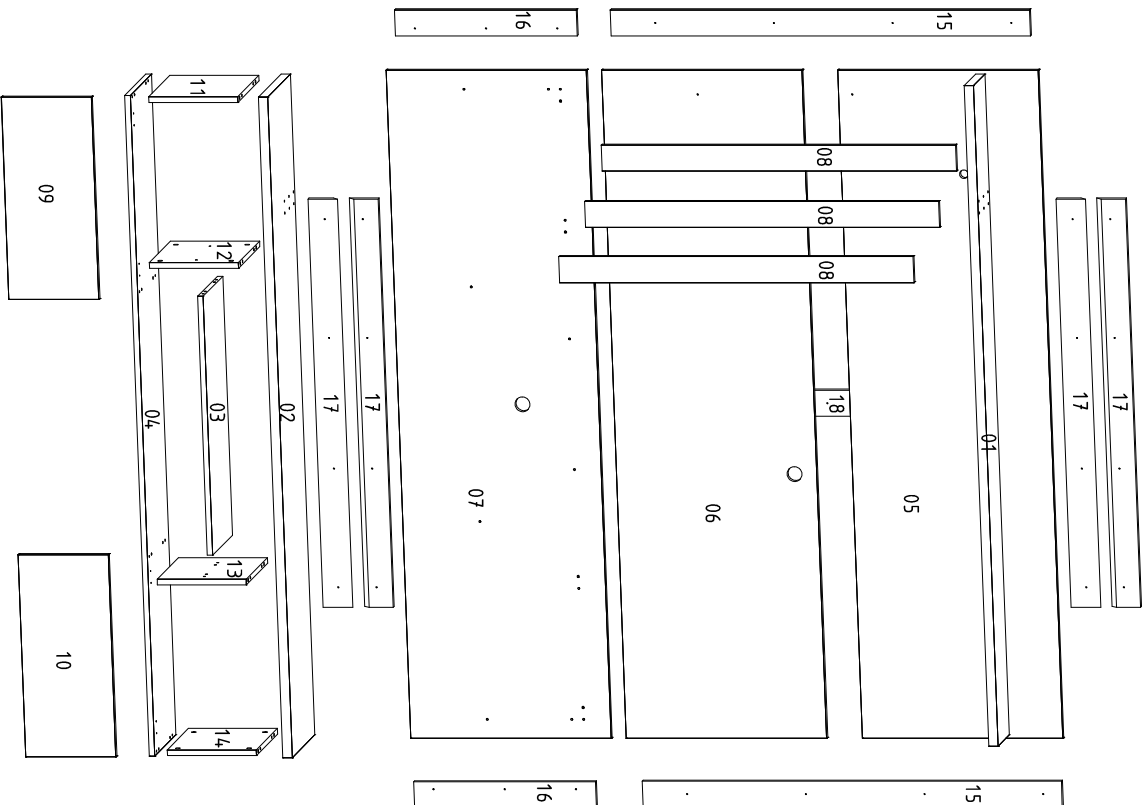

A		B		C		D		E		F											
G		H		I		J		K		L		M		N		O		P		Q	

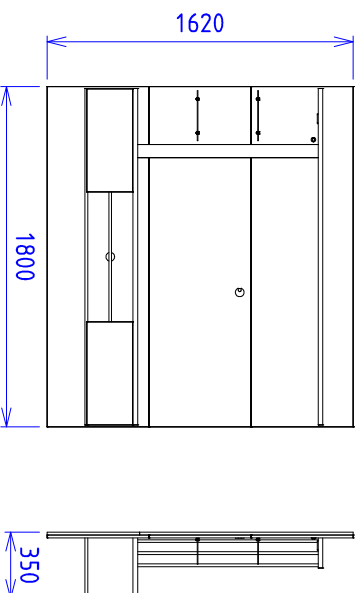

Produto montado - Comp: 1800mm / prof: 350mm / alt: 1620mm

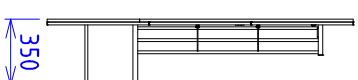

ETAPAS DA MONTAGEM / STAGES OF THE ASSEMBLY / ETAPAS DE LA ASAMBLEA

Para uma montagem perfeita do produto, siga a sequência:

For a perfect assembly of the product, it follows the sequence / Para un montaje perfecto del producto, sigue el secuencia

Passo 01
COLOCAR BUCHA DE FIXAÇÃO "I" NA PAREDE

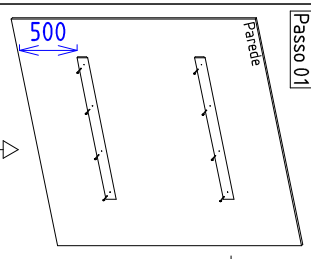

SUGESTÃO DE ALTURA DO PISO À PARTE INFERIOR DA TRAVESSA 17

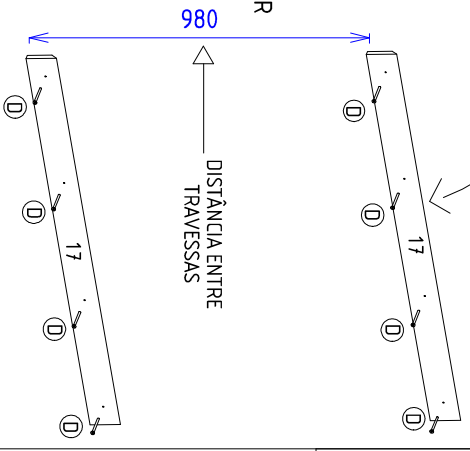

Passo 02

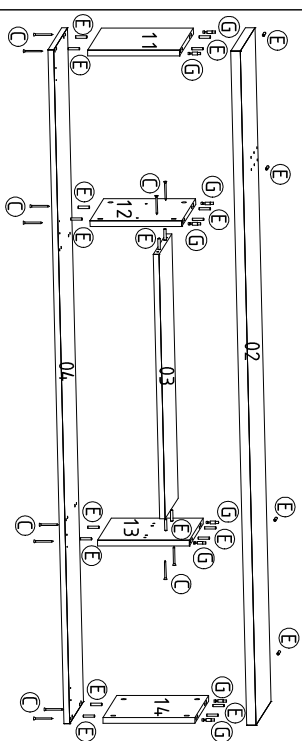

Passo 03 Vista Traseira

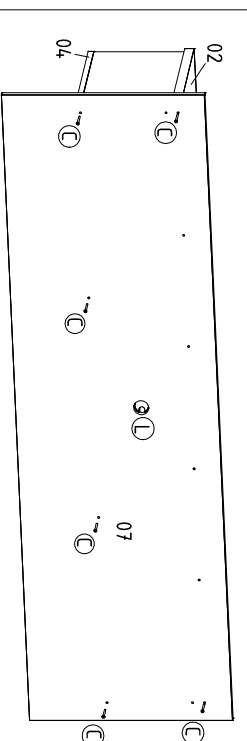

Passo 04 Vista Traseira

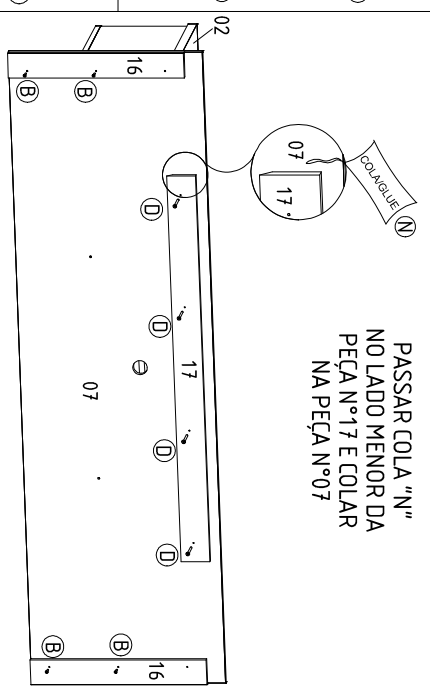

PASSAR COLA "N" NO LADO MENOR DA PEÇA N°17 E COLAR NA PEÇA N°07

OBS: OS PARAF "D" IRÃO FIXAR AS PEÇAS 02,17 E 07 JUNTAS, SEGUIR FURROS PARA FIXAÇÃO DA TRAVESSA.

Passo 05

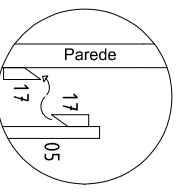
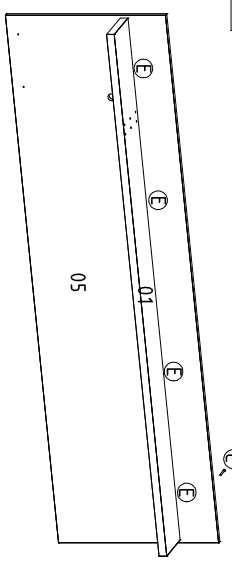

Vista Traseira

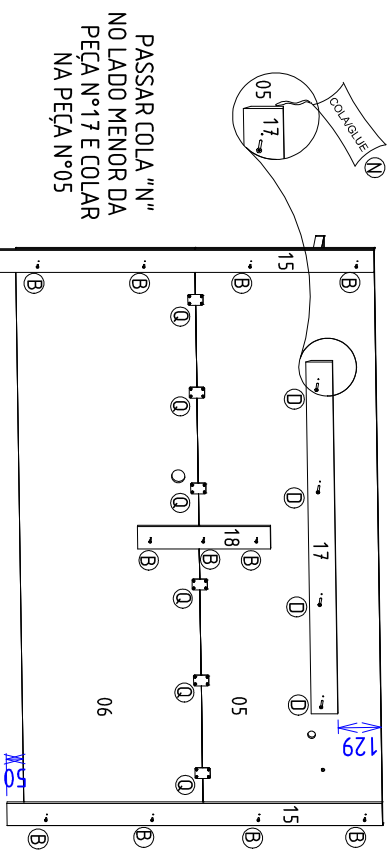

PASSAR COLA "N" NO LADO MENOR DA PEÇA N°17 E COLAR NA PEÇA N°05

Passo 06

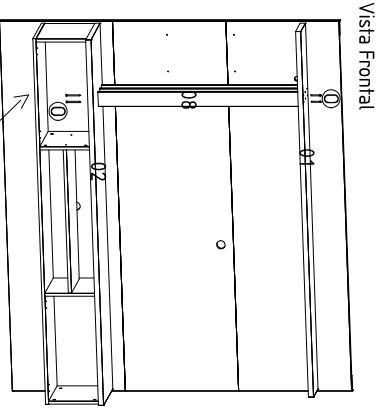

Vista Frontal

Vista lateral

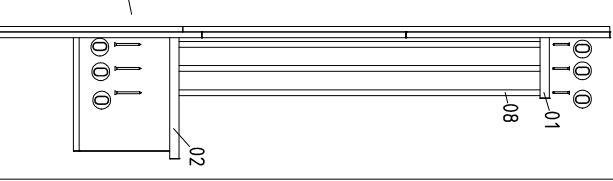

FIXAR PEÇAS 08 COM O PARAF "O" 4,5X60 (3X)

Passo 07

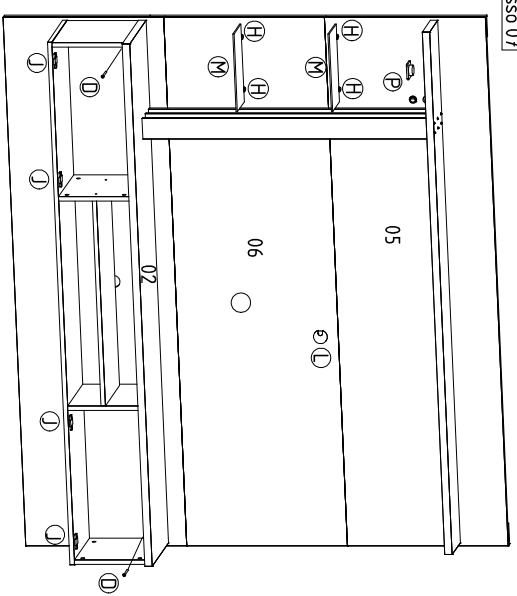

Porta Direita 10

Porta Esquerda 09