

MONTAGEM DA PORTA ABRINDO PARA A ESQUERDA  
 ARMADO DE LA PUERTA DE APERTURA IZQUIERDA  
 ASSEMBLE DOOR TO OPEN TO THE LEFT

08

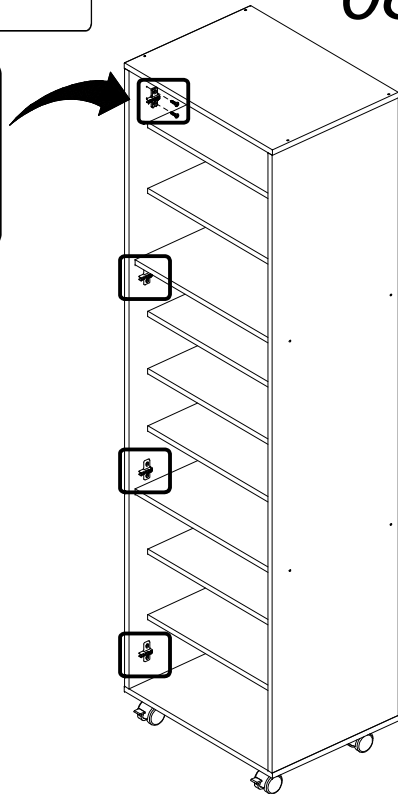

09

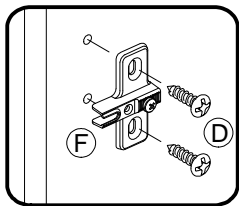
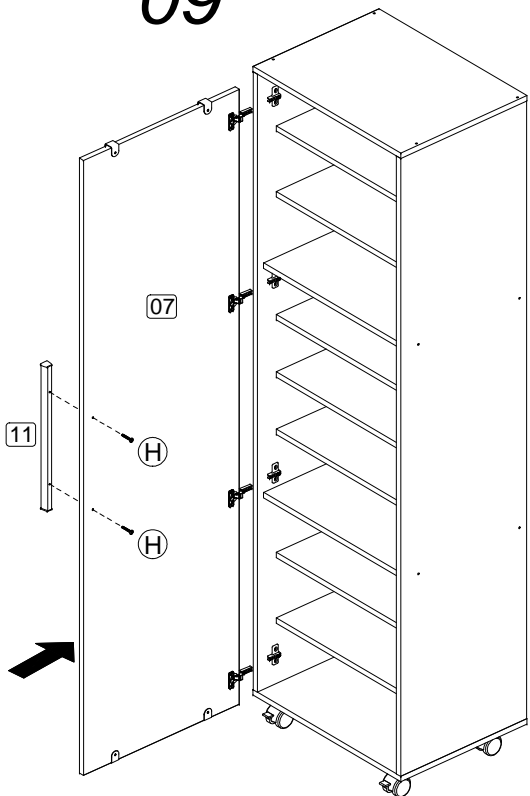

**ATENÇÃO!!!**  
 Utilize o giz de cera para dar acabamento nas arestas e correções de possíveis riscos nas peças.

**ATENCIÓN!!!**  
 Utilice el gis para los bordes y correcciones de posibles errores o daños en las piezas.

**ATTENTION!!!**  
 Use the crayons to finish edges and to fix possible damaged pieces.

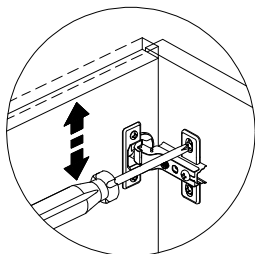

Regulagem Vertical  
 Ajuste Vertical  
 Vertical Adjustment

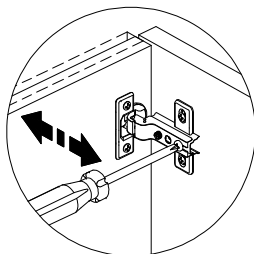

Regulagem Profundidade  
 Ajuste Profundidad  
 Depth Adjustment

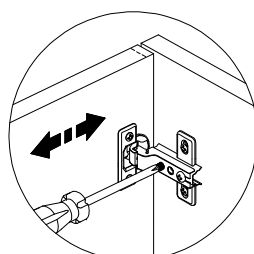

Regulagem Horizontal  
 Ajuste Horizontal  
 Horizontal Adjustment

8

INSTRUÇÕES DE MONTAGEM

INSTRUCTIVO DE ARMADO  
 ASSEMBLY INSTRUCTIONS

**Politorno**  
 Móveis

RSC 470 - km 203,3 BENTO GONÇALVES - RS - BRASIL  
 FONE: 54-3458.1300

sac@politorno.com.br  
 www.politorno.com.br

Organizador Coimbra  
 Organizer Cabinet Coimbra

Modelo  
 Modelo  
 Model

2437

Caso você precise da indicação de um montador, consulte o site [www.politorno.com.br](http://www.politorno.com.br). Temos profissionais capacitados para indicar nas principais cidades do Brasil.



KIT FERRAGEM  
 KIT HERRAJE  
 HARDWARE KIT

A	5,0x50	16
B		08
C		01
D	3,5x14	36
E	10x10	45
F		04
G		04
H	3,5 x 25	02
I		28
J		04
K	08x30	16
L	Giz / Gis / Crayons	03

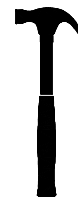

Rev 00

ANTES DE INICIAR A MONTAGEM, IDENTIFIQUE TODAS AS PEÇAS E ACESSÓRIOS.  
 ANTES DE EMPEZAR EL ARMADO, IDENTIFIQUE TODAS LAS PIEZAS Y ACCESORIOS.  
 BEFORE STARTING THE ASSEMBLY, IDENTIFY ALL PARTS AND ACCESSORIES.

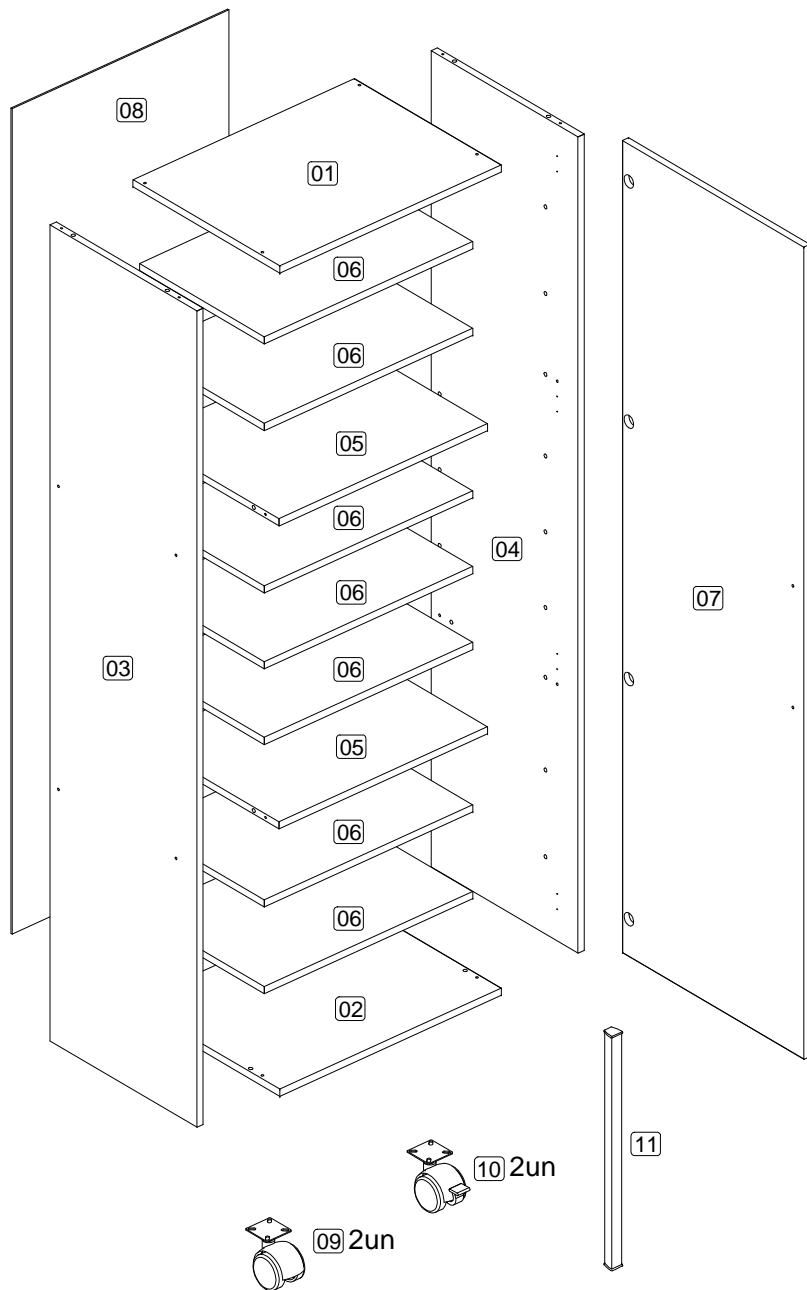

08

MONTAGEM DA PORTA ABRINDO PARA A DIREITA  
 ARMADO DE LA PUERTA DE APERTURA DERECHA  
 ASSEMBLE DOOR TO OPEN TO THE RIGHT

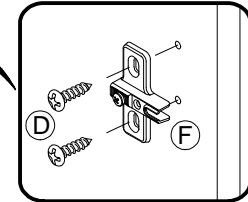
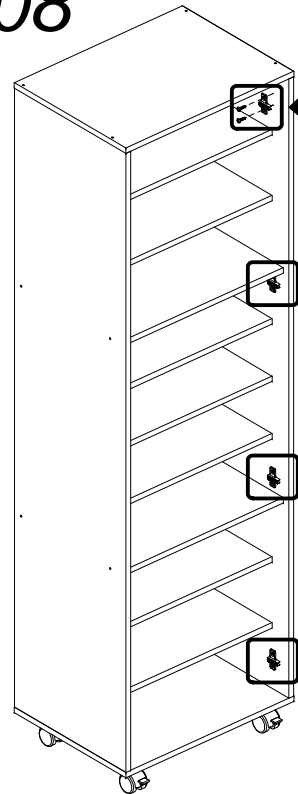

09

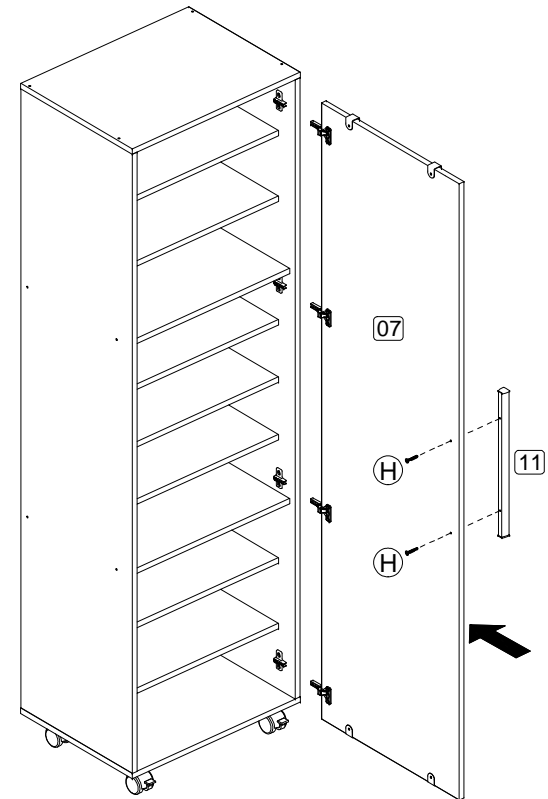

**ATENÇÃO!!!**  
 Utilize o giz de cera para dar acabamento nas arestas e correções de possíveis riscos nas peças.

**ATENCIÓN!!!**  
 Utilice el giz para los bordes y correcciones de posibles errores o daños en las piezas.

**ATTENTION!!!**  
 Use the crayons to finish edges and to fix possible damaged pieces.

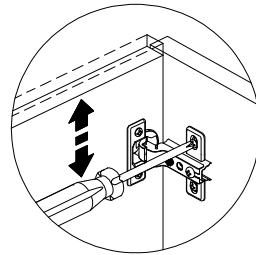

Regulagem Vertical  
 Ajuste Vertical  
 Vertical Adjustment

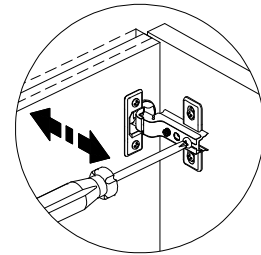

Regulagem Profundidade  
 Ajuste Profundidad  
 Depth Adjustment

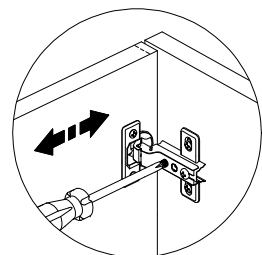

Regulagem Horizontal  
 Ajuste Horizontal  
 Horizontal Adjustment

06

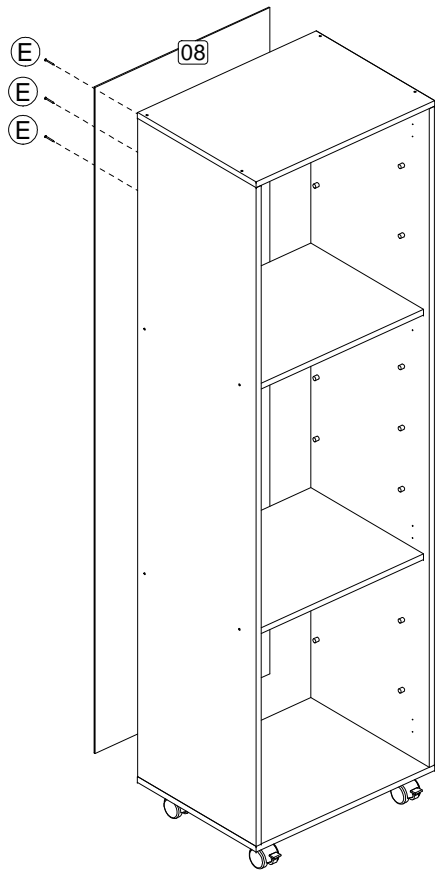

07

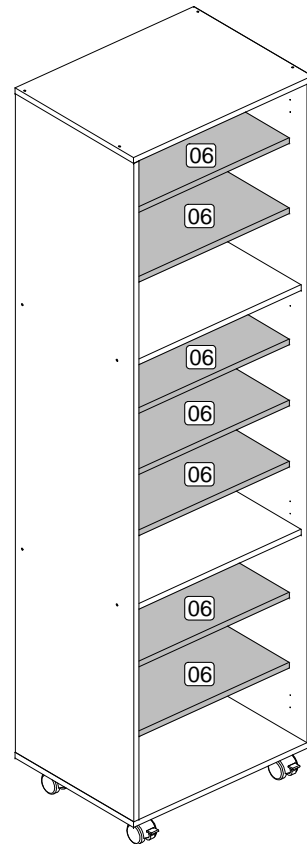

ETAPA DE PREPARAÇÃO DAS PEÇAS.  
 FASE DE PREPARACIÓN DE LAS PIEZAS.  
 STAGE OF PREPARATION OF THE PIECES.

01

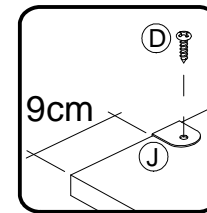
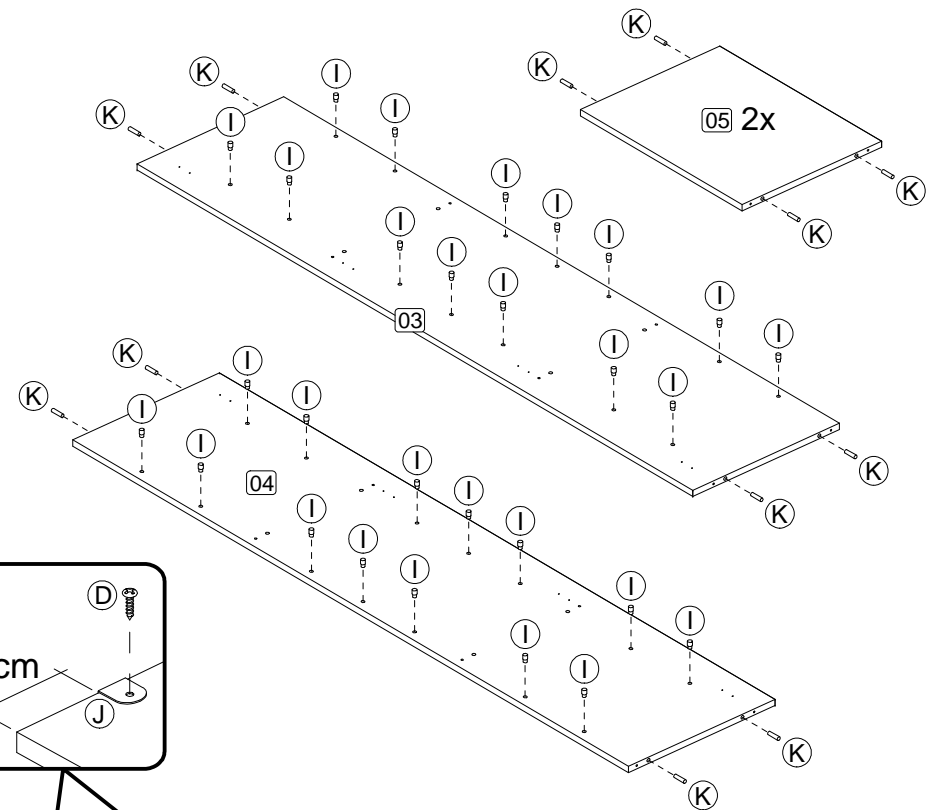

**IMPORTANT!**  
 É imprescindível a fixação do acessório "J" por segurança.  
**IMPORTANT!**  
 Es esencial fijar el accesorio "J" para la seguridad.  
**IMPORTANT!**  
 It's essential to fixing the accessory "J" for safety.

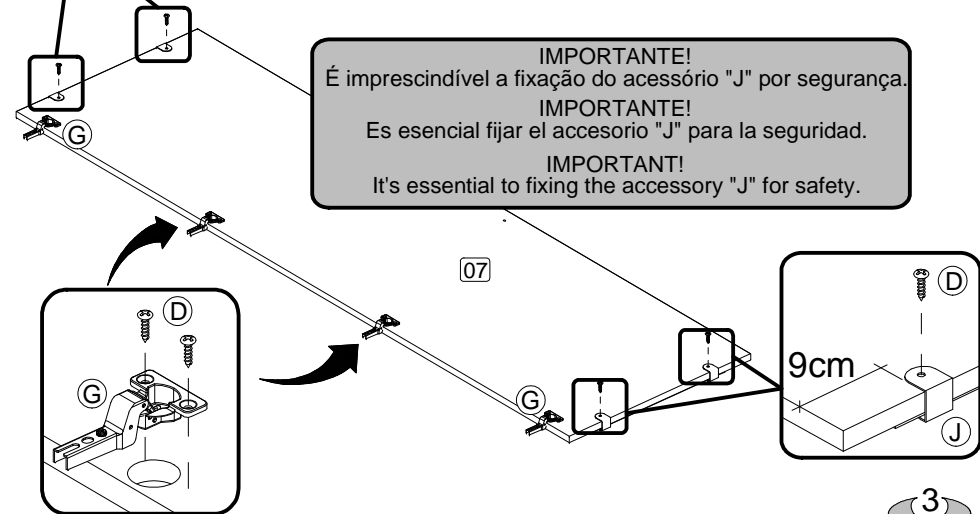

02

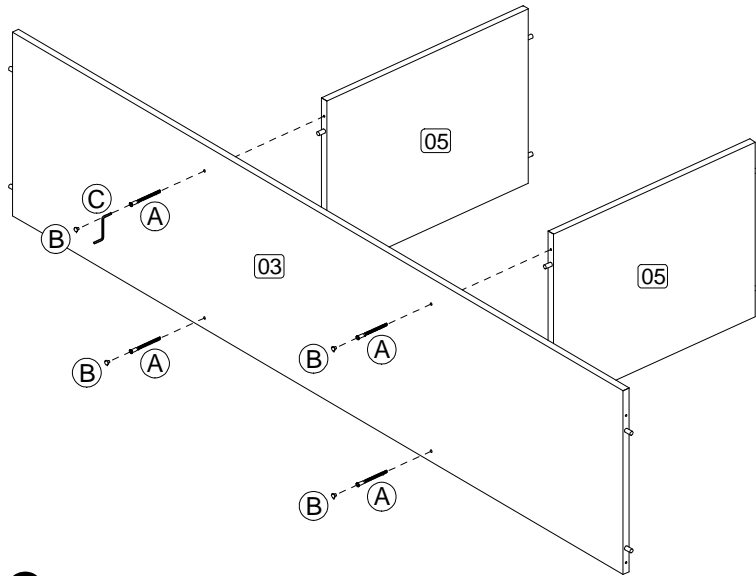

03

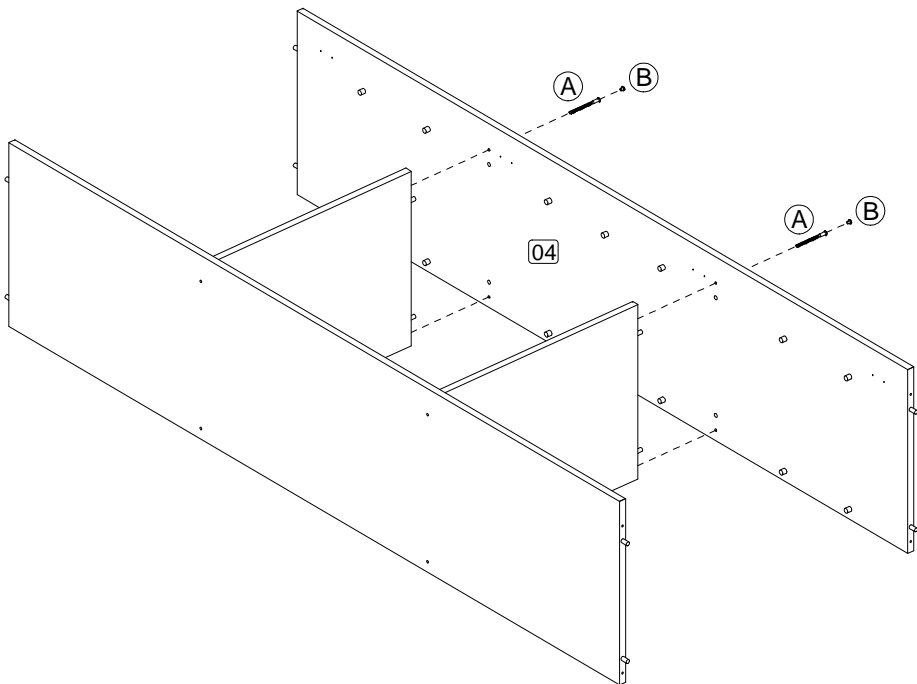

04

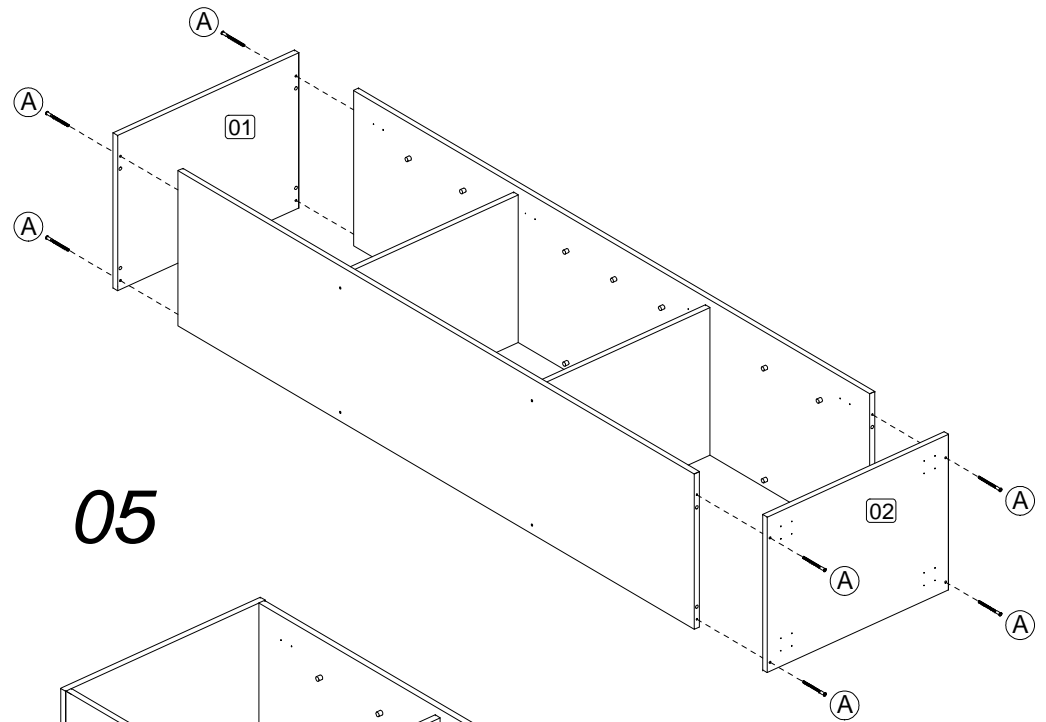

05

