

04

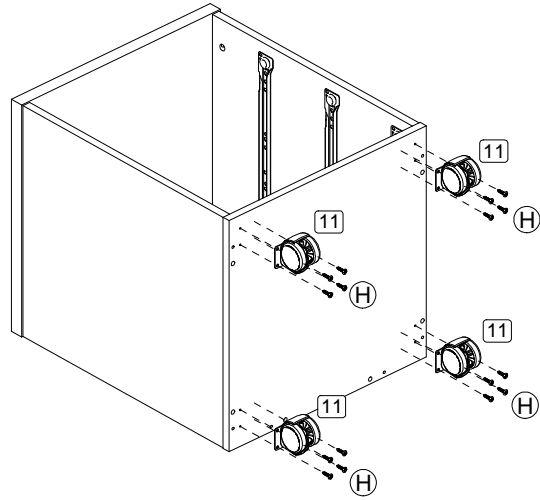

ATENÇÃO!!!
 Utilize o giz de cera para dar acabamento nas arestas e correções de possíveis riscos nas peças.

ATENCIÓN!!!
 Utilice el tiza para los bordes y correcciones de posibles errores o riesgos en piezas.

ATTENTION!!!
 Use the crayons to finish edges and to fix possible damaged pieces.

05 (3x)

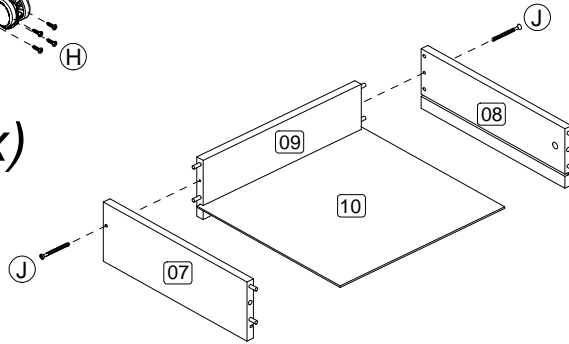

06 (3x)

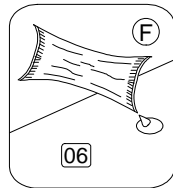
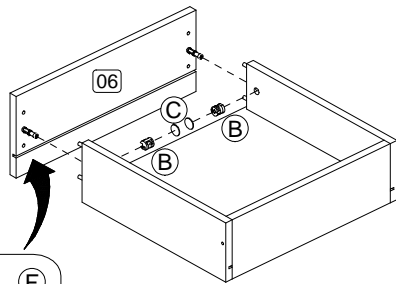

07 (3x)

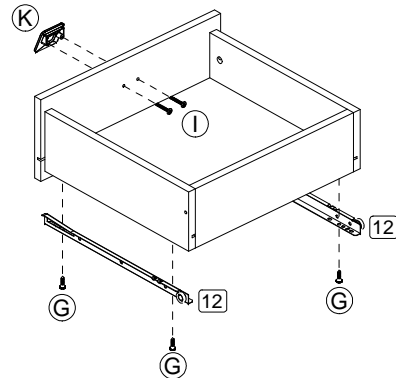

Gaveteiro 3 Gav. Cannes

Modelo
 Modelo
 Modelo

1191

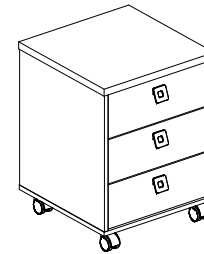

DÚVIDAS? ENVIE UM EMAIL PARA: sac@politorno.com.br
 DUDAS? ENVIE UN CORREO A: sac@politorno.com.br
 QUESTIONS? SEND AN EMAIL TO: sac@politorno.com.br

Caso você precise de um montador consulte o site www.politorno.com.br. Temos profissionais capacitados nas principais capitais do Brasil.

KIT FERRAGEM
 KIT HERRAJE
 HARDWARE KIT

A		10
B		10
C		06
D	06x30	24
E	08x30	12
F		01
G	3,0x14	24
H	3,5x14	16
I	3,5x25	06
J	4,5x45	12
K		03
L	Giz / Tiza / Crayons	03

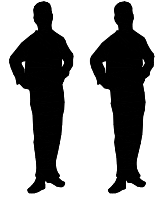

ANTES DE INICIAR A MONTAGEM, IDENTIFIQUE TODAS AS PEÇAS E ACESSÓRIOS.
 ANTES DE EMPEZA EL ARMADO, IDENTIFIQUE TODAS LAS PIEZAS Y ACCESORIOS.
 BEFORE STARTING THE ASSEMBLY, IDENTIFY ALL PARTS AND ACCESSORIES.

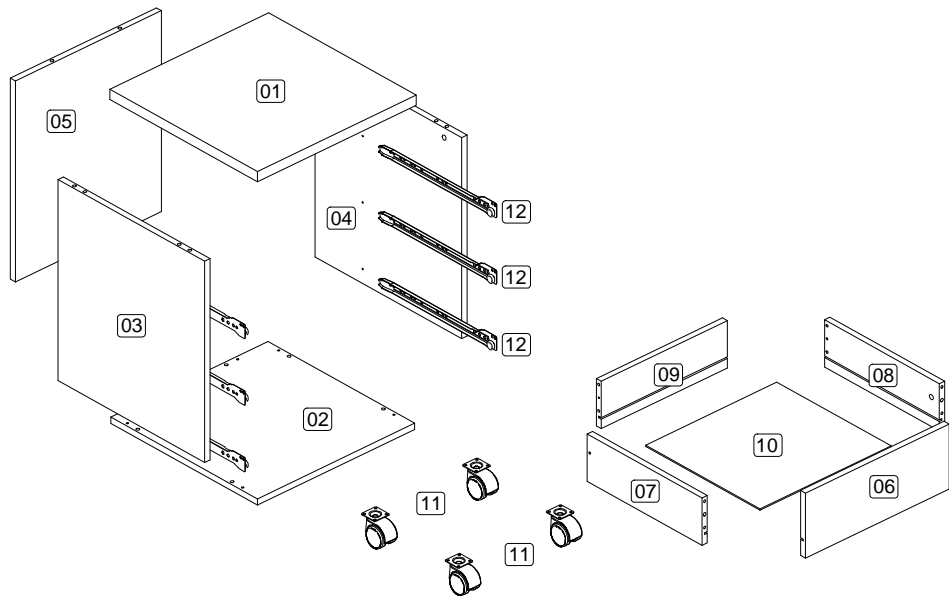

ETAPA DE PREPARAÇÃO DAS PEÇAS.
 FASE DE PREPARACIÓN DE LAS PIEZAS.
 STAGE OF PREPARATION OF THE PIECES.

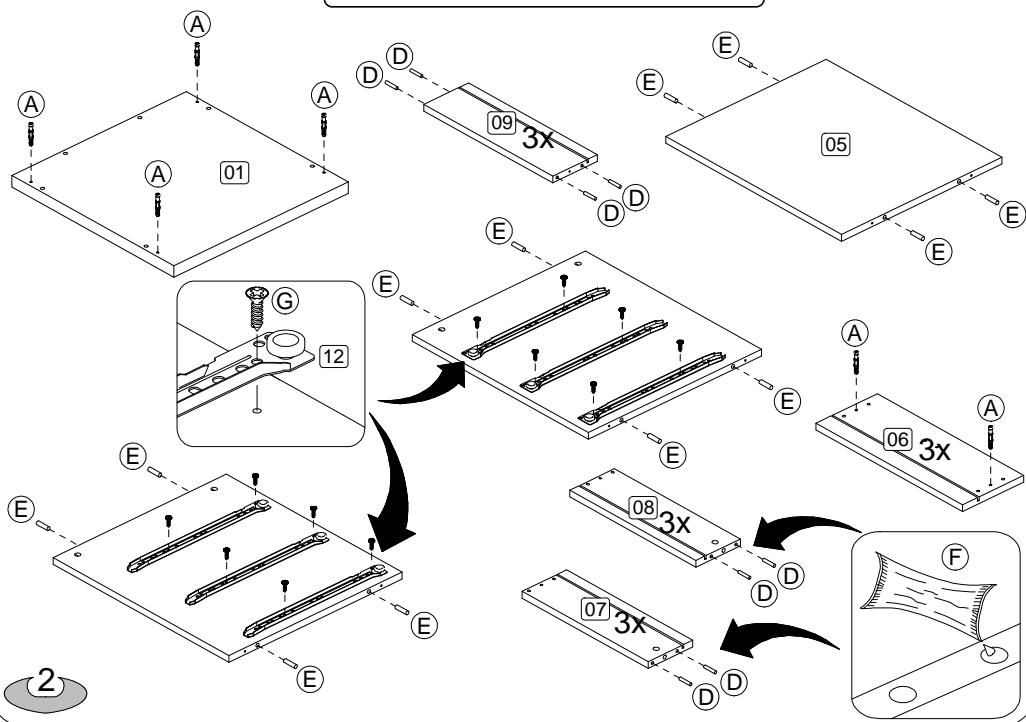

01

02

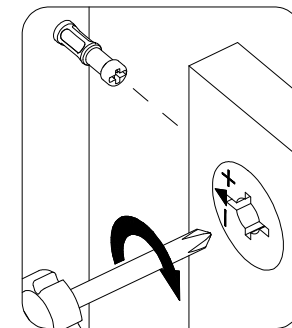
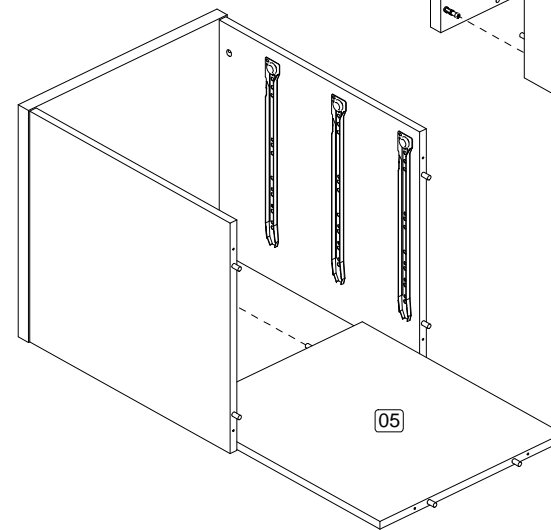
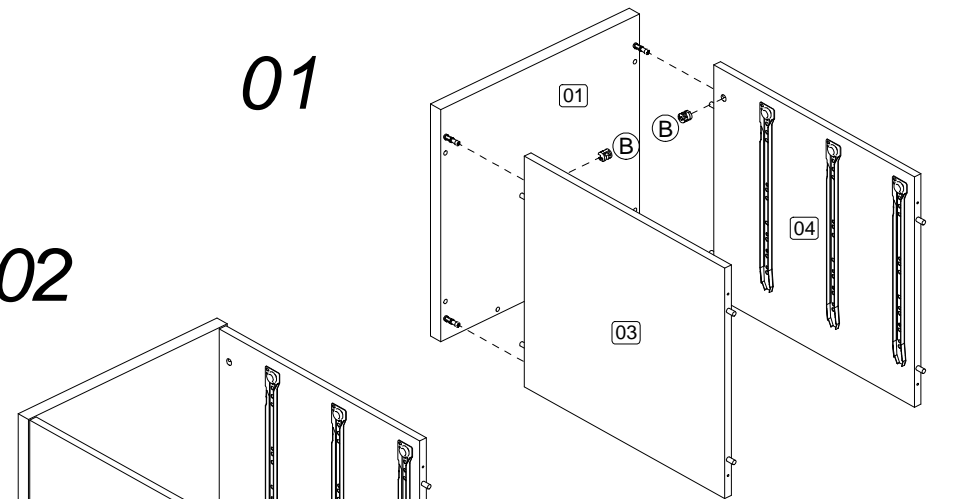

03

