

04

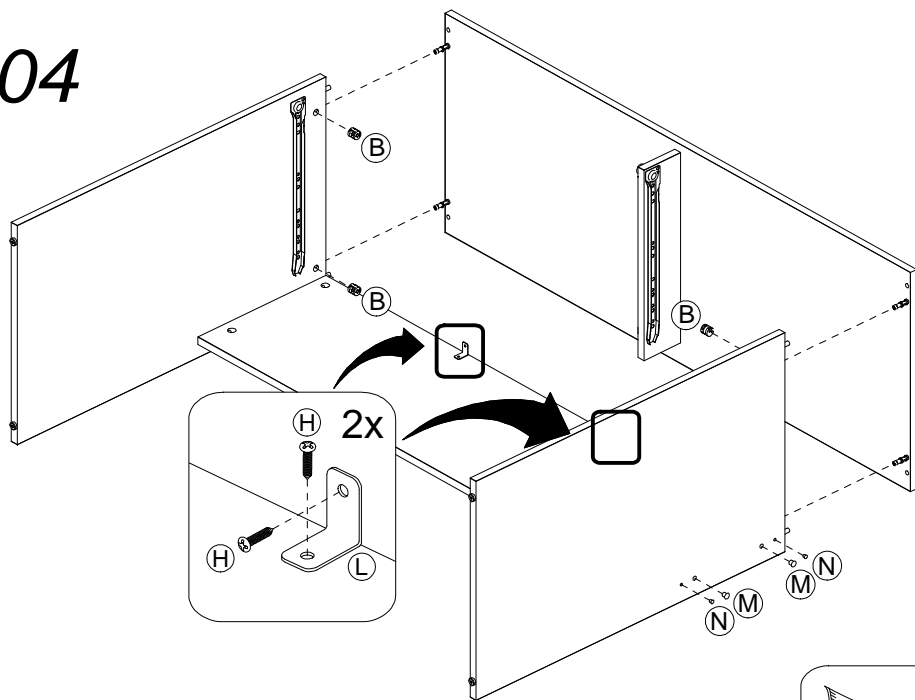

05 (2x)

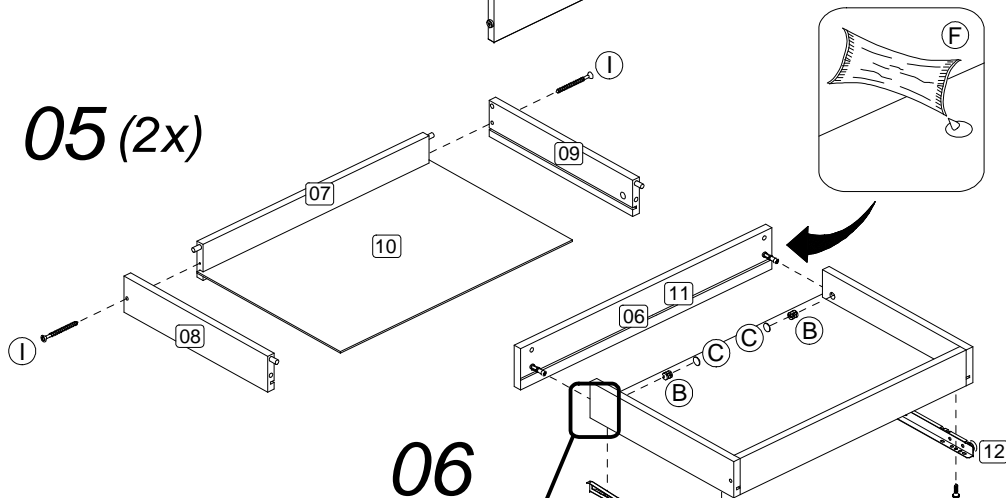

06

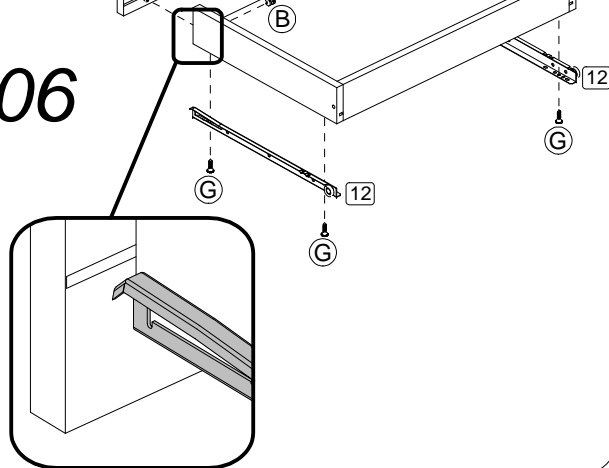

ATENÇÃO!!!
Utilize o giz de cera para dar acabamento nas arestas e correções de possíveis riscos nas peças.

ATENCIÓN!!!
Utilice el gis para los bordes y correcciones de posibles errores o daños en las piezas.

ATTENTION!!!
Use the crayons to finish edges and to fix possible damaged pieces.

4



RSC 470 - km 203,3 BENTO GONÇALVES - RS - BRASIL
FONE: 54-3458.1300
www.politorno.com.br

INSTRUÇÕES DE MONTAGEM
INSTRUCTIVO DE ARMADO
ASSEMBLY INSTRUCTIONS

Mesa Lindóia
Mesa de Computación
Office Desk

Modelo
Modelo
Modelo

1194

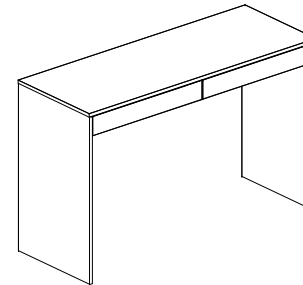

Caso você precise da indicação de um montador, consulte o site www.politorno.com.br. Temos profissionais capacitados para indicar nas principais cidades do Brasil.

DÚVIDAS? ENVIE UM EMAIL PARA: sac@politorno.com.br
DUDAS? ENVIE UN CORREO A: sac@politorno.com.br
QUESTIONS? SEND AN EMAIL TO: sac@politorno.com.br

KIT FERRAGEM
KIT HERRAJE
HARDWARE KIT

A		14
B		14
C		06
D	6,0x08	04
E	08x30	18
F		01
G	3,0x14	12
H	3,5x14	04
I	4,5x45	04
J		04
K		04
L		02
M	8mm	04
N	5mm	04
O	Giz / Gis / Crayons	04

Rev 02



ANTES DE INICIAR A MONTAGEM, IDENTIFIQUE TODAS AS PEÇAS E ACESSÓRIOS.
 ANTES DE EMPEZAR EL ARMADO, IDENTIFIQUE TODAS LAS PIEZAS Y ACCESORIOS.
 BEFORE STARTING THE ASSEMBLY, IDENTIFY ALL PARTS AND ACCESSORIES.

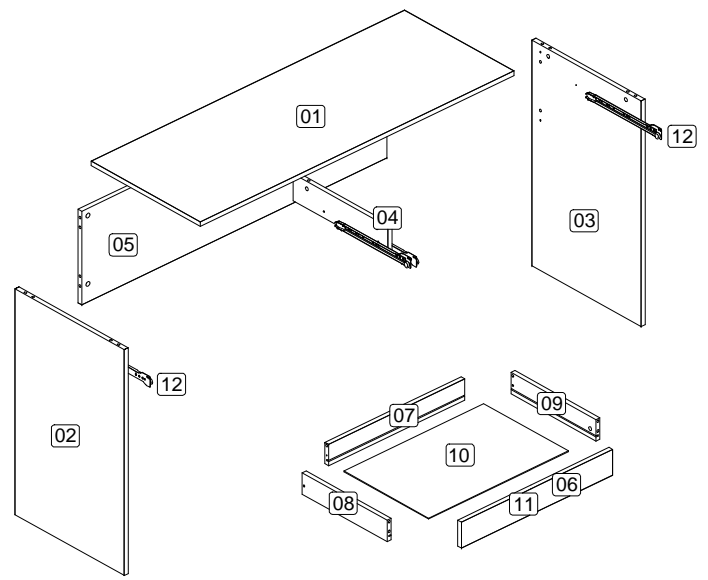

ETAPA DE PREPARAÇÃO DAS PEÇAS.
 FASE DE PREPARACIÓN DE LAS PIEZAS.
 STAGE OF PREPARATION OF THE PIECES.

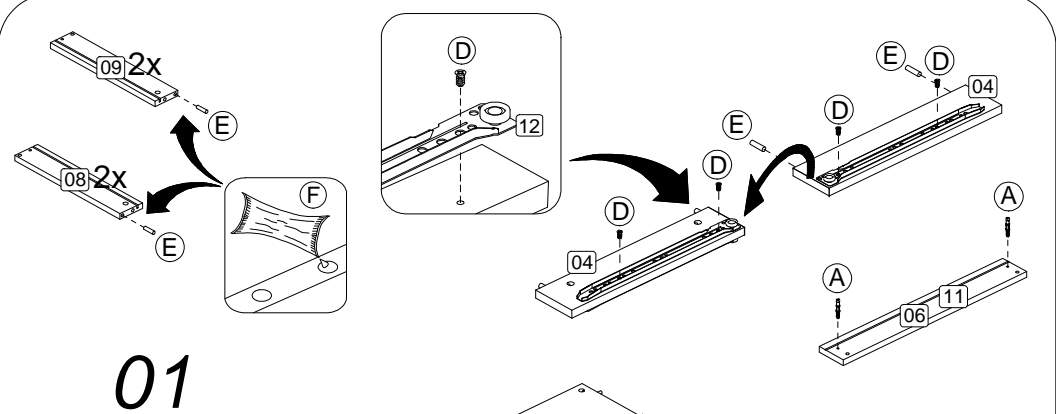
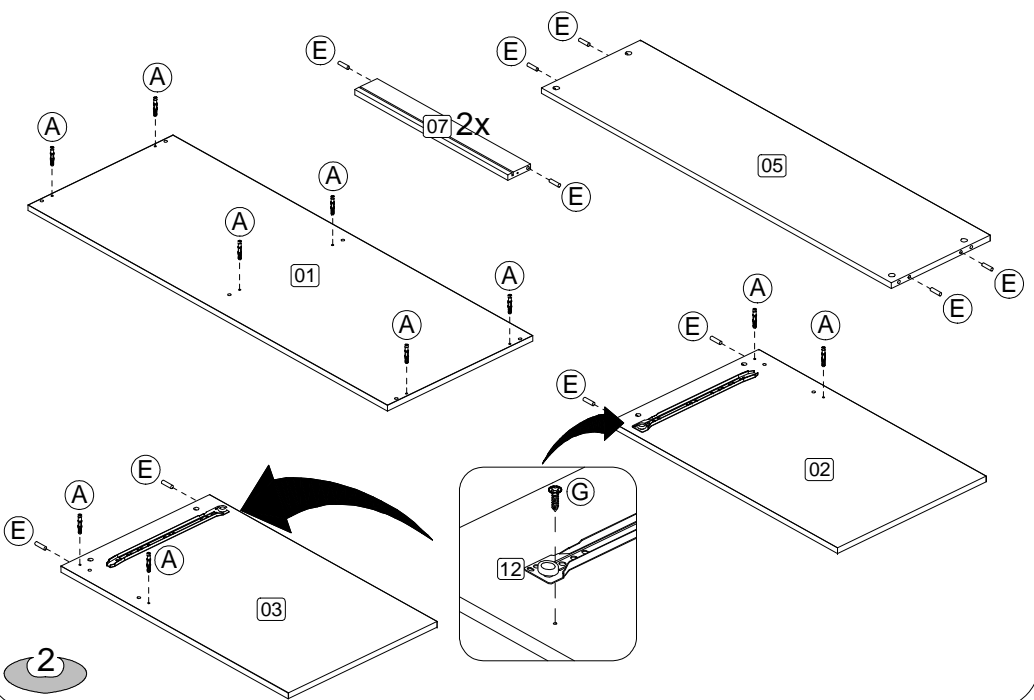

01

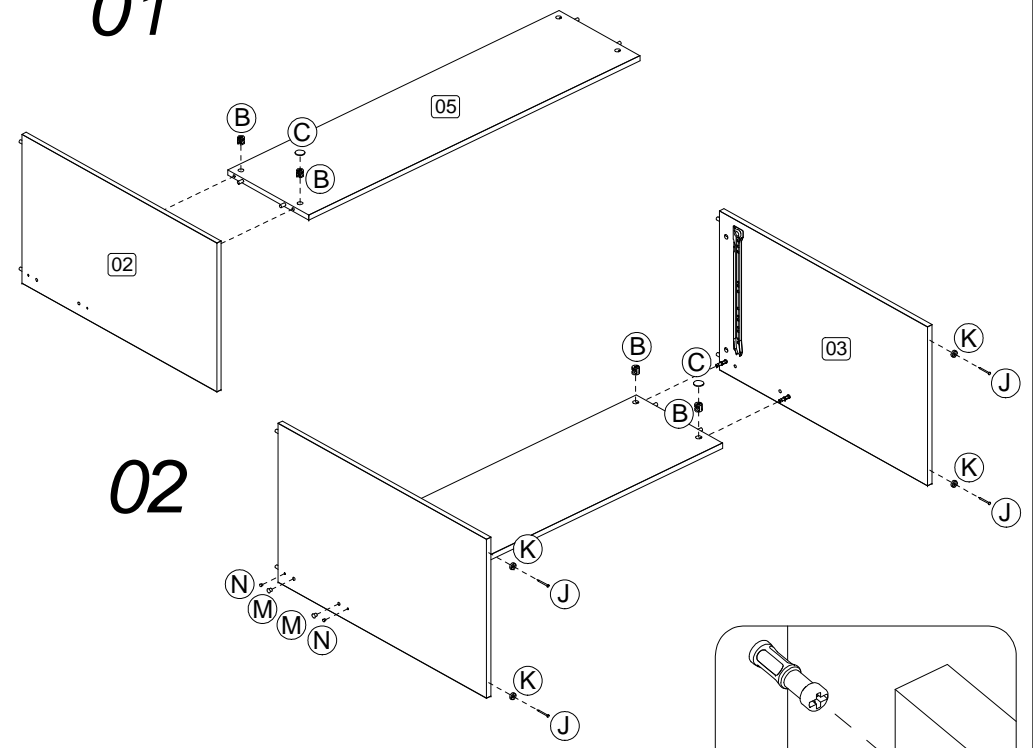

02

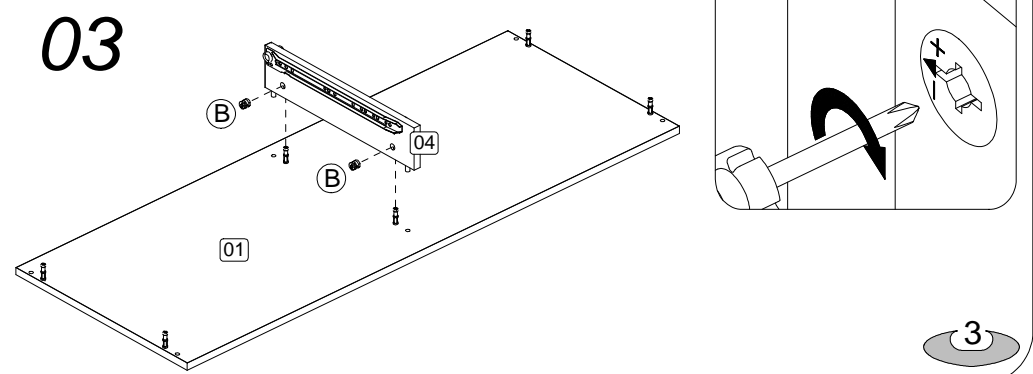

03